

VANDAL - RESISTANT FIXTURES

Provides extra protection in challenging environments

This line of signal fixtures are made of tough materials and smoother tighter design to minimize the possibility of damage. It features stainless steel faceplates and plastic-free buttons. These buttons use a standard blue illumination (red, green or white are optional). The pry-resistant hall jamb symbols and buttons are mounted flush with the door frame, making them harder to vandalize.

All signal fixtures are certified by a Nationally Recognized Testing Lab (NRTL) before installation per ASME A17.5.

Features and benefits

- Meets all National Fire Service codes for the U.S. and Canada
- Braille plates feature durable markings that meet the most stringent requirements
- LED-illuminated buttons available in red, green, white or blue

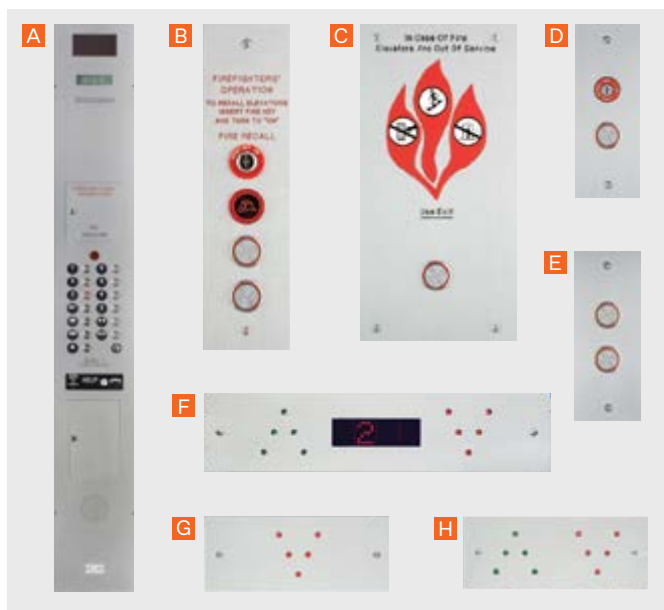

- A** Car operating panel
- B** Intermediate hall station with fire service devices
- C** Intermediate hall station, fire service & Appendix H/O signage
- D** Terminal hall station with fire service key switch
- E** Intermediate hall station
- F** Combo hall lantern / position indicator
- G** Terminal hall lantern (arrows)
- H** Intermediate hall lantern (arrows)
- I** Push button

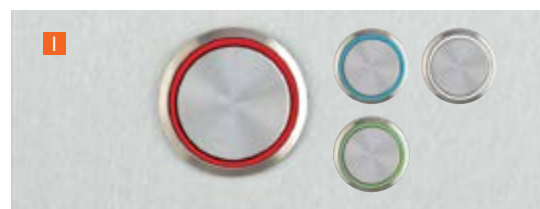

Performance	Safety	Code	Aesthetics	Sustainability

For more information, visit www.tkelevator.com/us or contact your sales representative.